

Bergsteiger Monaco: additional assembly instructions

Assembly the support wheels

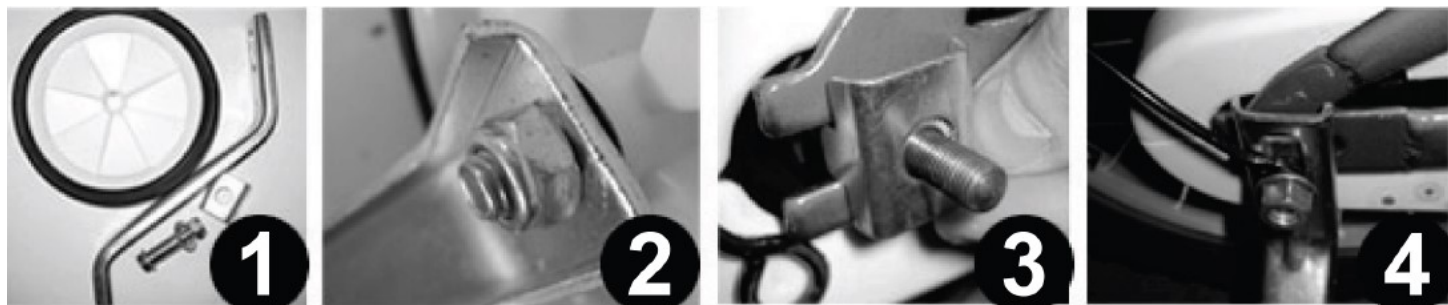

Take the long bolt and slide it through the tire. Put the washer over it, then the jockey wheel retaining iron and screw everything tight with the nut (picture 2). Do the same with the other jockey wheel. Now remove the cap nuts on the axle of the rear wheel. Put the metal lock onto the axle (picture 3). Now you can tighten the jockey wheel again with the axle nut. **The support wheels should sit firmly on the axle.**

Handlebar adjustment

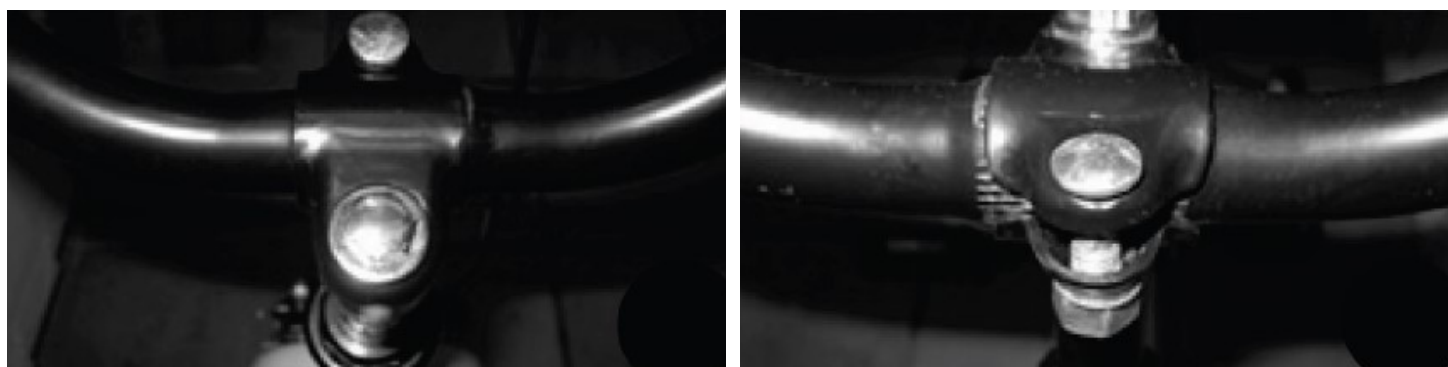

The height and the angle of the handlebar can be adjusted by loosening the steering head screw (picture 1). If you loosen the clamping screw (image 2), you have the option of adjusting the incline of the handlebars to the needs of the child.

Note:

As a small thank you, we have included a large DingDong bell. However, this can also be exchanged for the black standard bell if required (also included).

👍 We wish you a good ride and a lot of fun with your new bike!

